

05/03/95

CONTRACT: DA00383 WBS ELEMENT: 2018CPT.01.13.20481.1

STATE OF NORTH CAROLINA
DIVISION OF HIGHWAYS
HYDE COUNTY

STATE	STATE PROJECT REFERENCE NO.	SHEET NO.	TOTAL SHEETS
N.C.	2018CPT.01.13.20481.1	1	
STATE PROJ. NO.	F.A. PROJ. NO.	DESCRIPTION	
2018CPT.01.13.20481.1		MAP 1	



LOCATIONS: MAP 1 - SR 1304 - TURNPIKE RD (FROM SR 1305 TO US 264 SWINDELL FORK)

TYPE OF WORK: RESURFACING

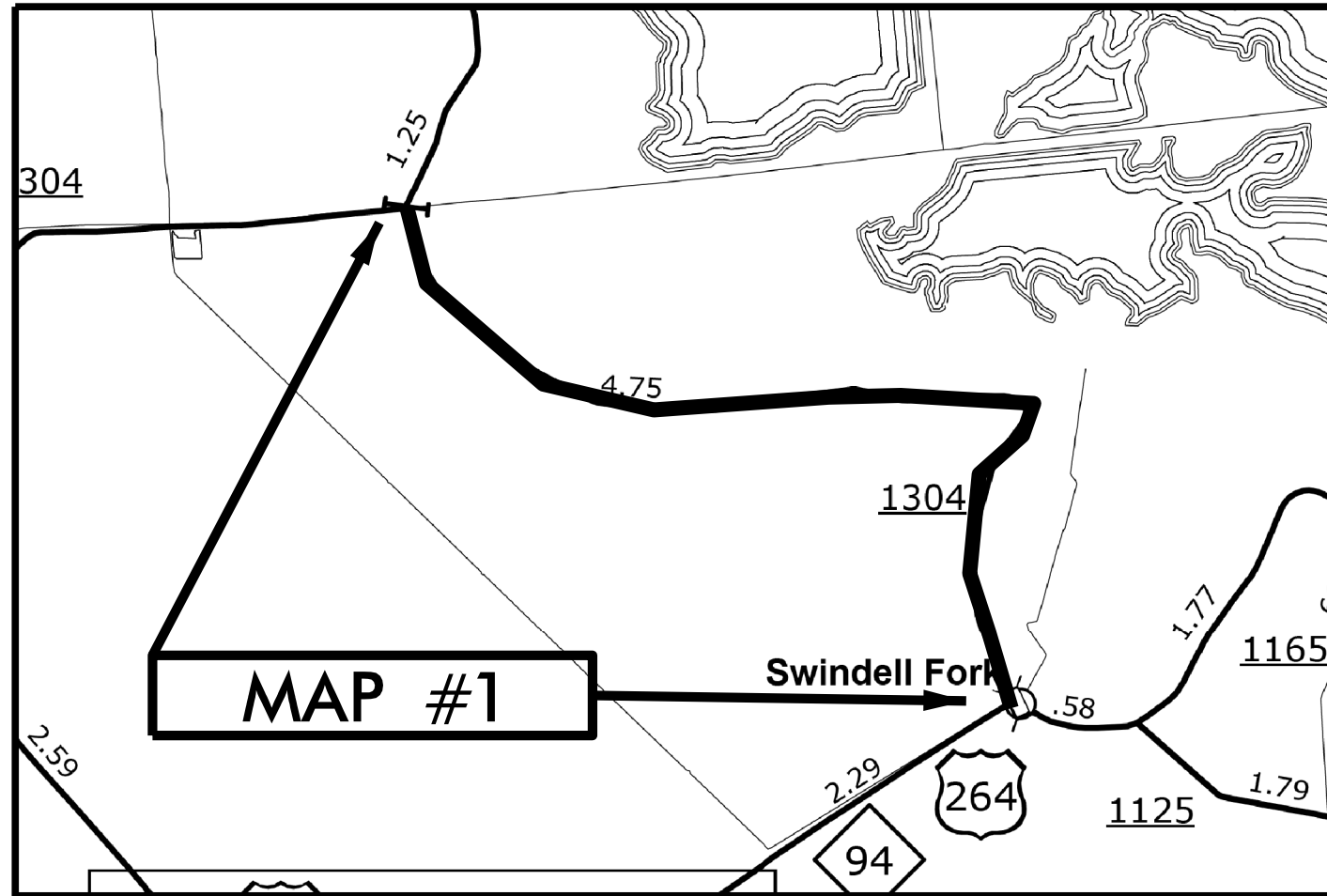

NOT TO SCALE

PROJECT LENGTH

LENGTH OF MAP 1 = 4.75 MI.

Prepared in the Office of:
DIVISION OF HIGHWAYS
113 Airport Dr., Edenton NC, 27932

2012 STANDARD SPECIFICATIONS

LETTING DATE:

W.B. HOBBS, P.E.
DIVISION PROJECT MANAGER

C.E. SLACHTA
DIVISION PROPOSALS ENGINEER

DIVISION OF HIGHWAYS
STATE OF NORTH CAROLINA

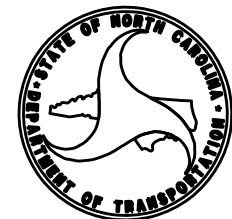

09/08/09

CONTRACT: DA00383 WBS ELEMENT: 2018CPT.01.13.20891.1

STATE OF NORTH CAROLINA
DIVISION OF HIGHWAYS

TYRRELL COUNTY

STATE	STATE PROJECT REFERENCE NO.	SHEET NO.	TOTAL SHEETS
N.C.	2018CPT.01.13.20891.1	2	
STATE PROJ. NO.	F.A. PROJ. NO.	DESCRIPTION	
2018CPT.01.13.20891.1		MAP 2	



LOCATION: MAP 2 - SR 1310 - OLD SWAM RD (FROM SR 1309 TO SR 1314)

TYPE OF WORK: RESURFACING

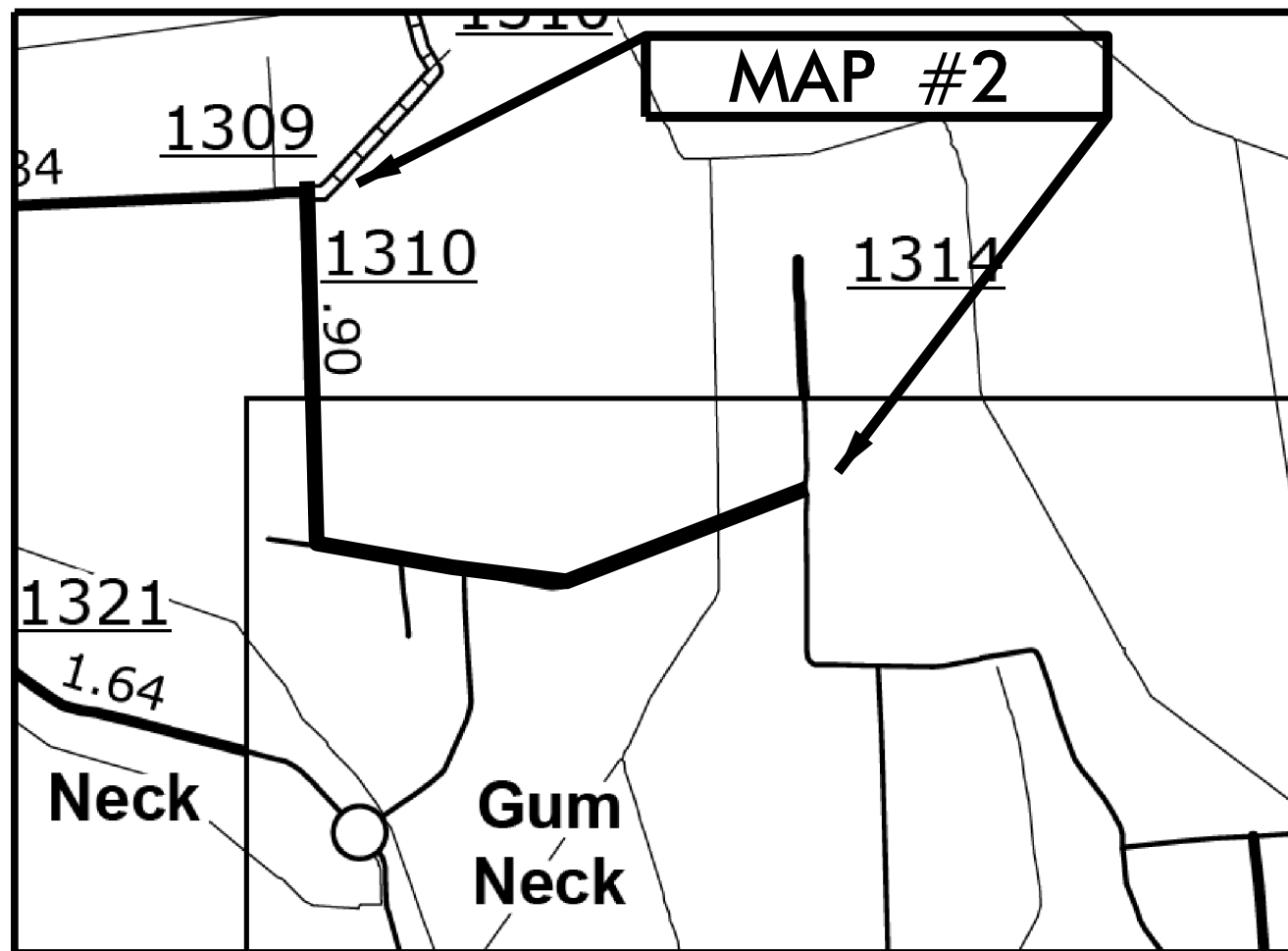

NOT TO SCALE

PROJECT LENGTH

LENGTH OF MAP 2 = 2.21 MI.

Prepared in the Office of:
DIVISION OF HIGHWAYS
113 Airport Dr., Edenton NC, 27932

2012 STANDARD SPECIFICATIONS

LETTING DATE:

W.B. HOBBS, P.E.
DIVISION PROJECT MANAGER

C.E. SLACHTA
DIVISION PROPOSALS ENGINEER

DIVISION OF HIGHWAYS
STATE OF NORTH CAROLINA



09/08/99

CONTRACT: DA00383 WBS ELEMENT: 2018CPT.01.13.20891.1

STATE OF NORTH CAROLINA
DIVISION OF HIGHWAYS

TYRRELL COUNTY

STATE	STATE PROJECT REFERENCE NO.	SHEET NO.	TOTAL SHEETS
N.C.	2018CPT.01.13.20891.1	3	
STATE PROJ. NO.	P.A. PROJ. NO.	DESCRIPTION	
2018CPT.01.13.20891.1		MAPS 3 - 6	

LOCATIONS: MAP 3 - SR 1314 - GUM NECK RD (FROM SR 1310 TO SR 1315)
 MAP 4 - SR 1311 - CALIFORNIA RD (FROM SR 1310 TO DEAD END)
 MAP 5 - SR 1318 - REEK RD (FROM SR 1314 TO SR 1318)
 MAP 6 - SR 1318 - REEK RD (FROM SR 1316 TO SR 1318)

TYPE OF WORK: RESURFACING

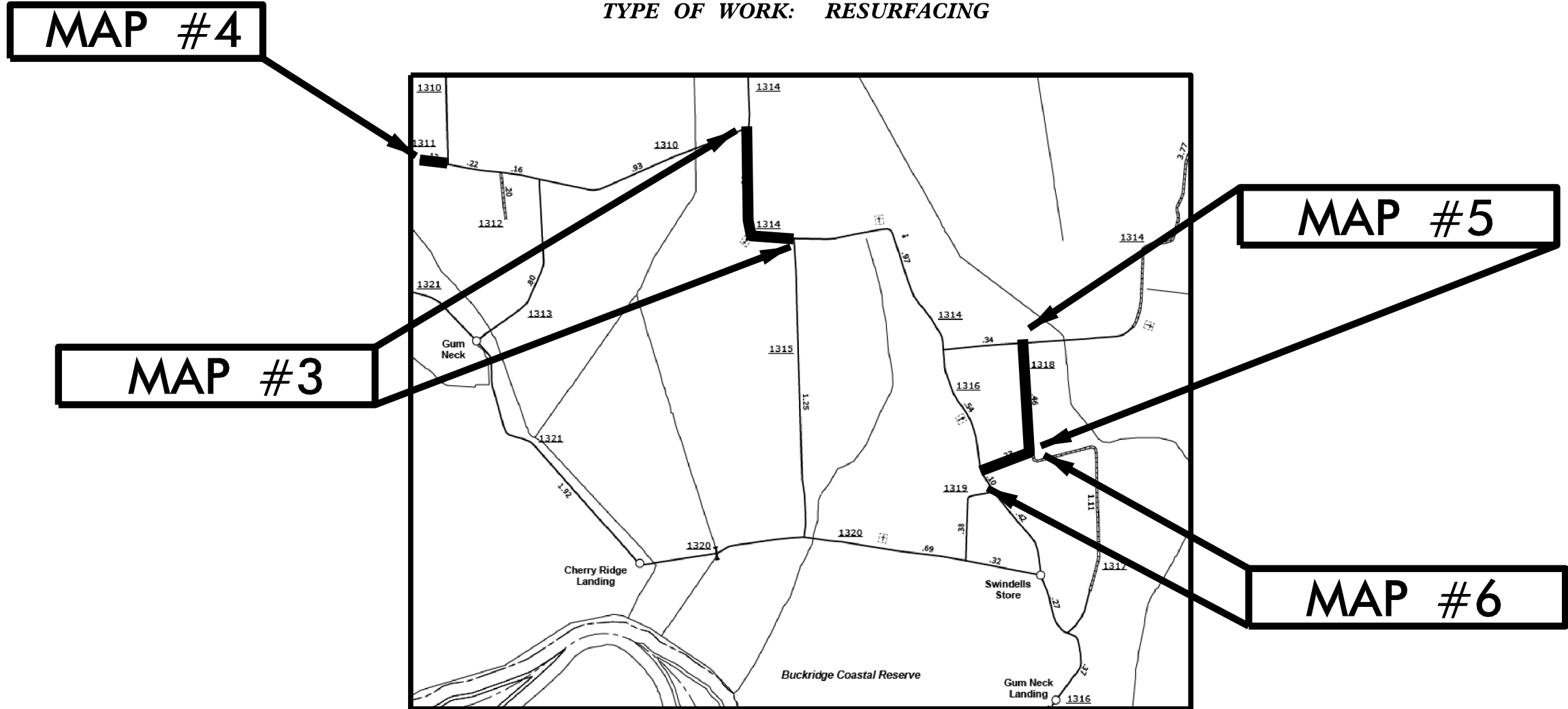

NOT TO SCALE

PROJECT LENGTH

- LENGTH OF MAP 3 = 0.64 MI.
- LENGTH OF MAP 4 = 0.12 MI.
- LENGTH OF MAP 5 = 0.46 MI.
- LENGTH OF MAP 6 = 0.23 MI.

Prepared in the Office of:
DIVISION OF HIGHWAYS
 113 Airport Dr., Edenton NC, 27932

2012 STANDARD SPECIFICATIONS

LETTING DATE: _____

W.B. HOBBS, P.E.
 DIVISION PROJECT MANAGER

C.E. SLACHTA
 DIVISION PROPOSALS ENGINEER

DIVISION OF HIGHWAYS
STATE OF NORTH CAROLINA

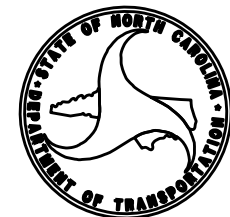

09/08/99

CONTRACT: DA00383 WBS ELEMENT: 2018CPT.01.13.20891.1

STATE OF NORTH CAROLINA
DIVISION OF HIGHWAYS

TYRRELL COUNTY

STATE	STATE PROJECT REFERENCE NO.	SHEET NO.	TOTAL SHEETS
N.C.	2018CPT.01.13.20891.1	4	
STATE PROJECT NO.	F.A. PROJECT NO.	DESCRIPTION	
2018CPT.01.13.20891.1		MAPS 7 - 8	

LOCATIONS: MAP 7 - SR 1209 FORT LANDING RD (FROM SR 1221 TO DEAD END)

MAP 8 - SR 1224 - COVE RD (FROM SR 1223 TO DEAD END)

TYPE OF WORK: RESURFACING

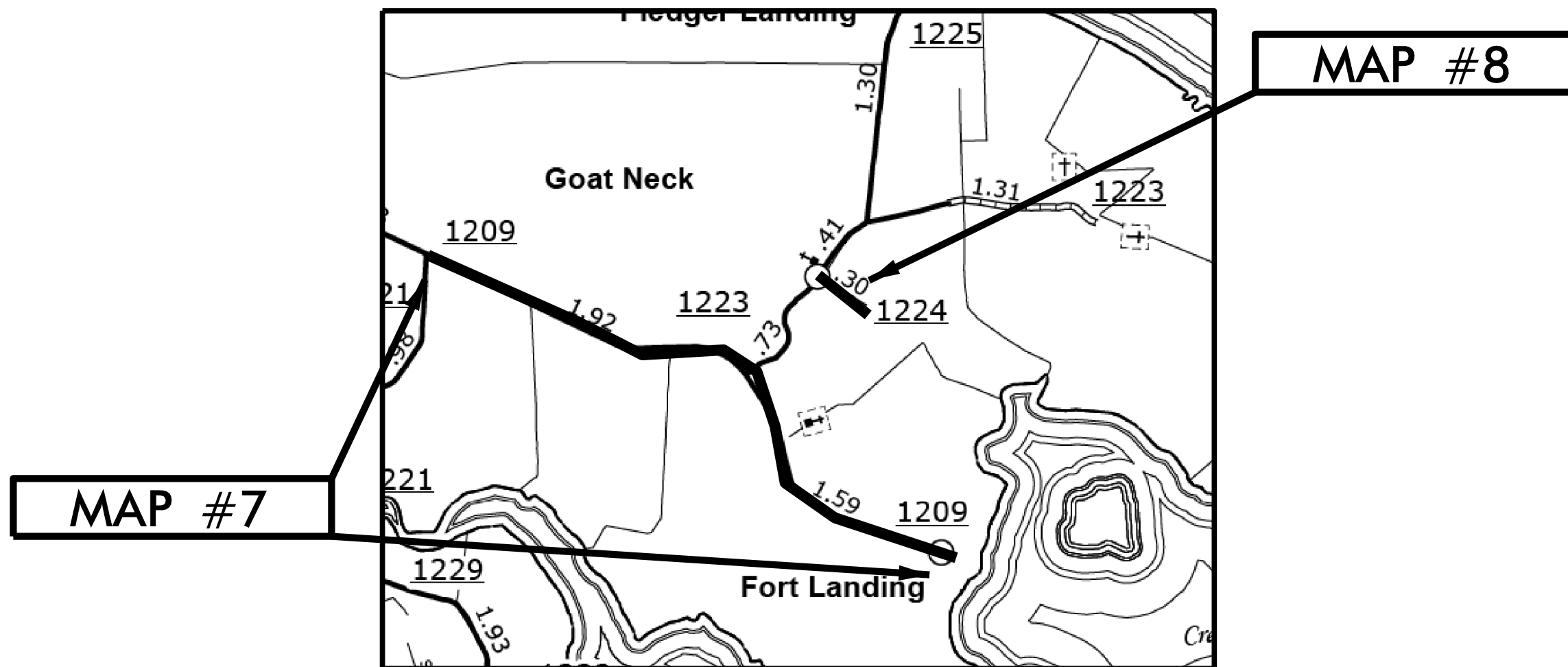

MAP #7

MAP #8

NOT TO SCALE

PROJECT LENGTH

LENGTH OF MAP 7 = 3.66 MI.

LENGTH OF MAP 8 = 0.21 MI.

Prepared in the Office of:
DIVISION OF HIGHWAYS
113 Airport Dr., Edenton NC, 27932

2012 STANDARD SPECIFICATIONS

LETTING DATE:

W.B. HOBBS, P.E.
DIVISION PROJECT MANAGER

C.E. SLACHTA
DIVISION PROPOSALS ENGINEER

DIVISION OF HIGHWAYS
STATE OF NORTH CAROLINA

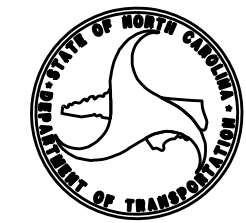

09/08/99

CONTRACT: DA00383 WBS ELEMENT: 2018CPT.01.13.20941.1

STATE OF NORTH CAROLINA DIVISION OF HIGHWAYS **WASHINGTON COUNTY**

STATE	STATE PROJECT REFERENCE NO.	SHEET NO.	TOTAL SHEETS
N.C.	2018CPT.01.13.20941.1	5	
STATE PROJ. NO.	F.A. PROJ. NO.	DESCRIPTION	
2018CPT.01.13.20941.1		MAPS 9 - 12	

LOCATIONS: MAP 9 - SR 1310 - ALLIGOOD RD (FROM SR 1303 TO TYRRELL CO LINE)
 MAP 10 - SR 1310 - 6TH ST (FROM SR 1142 TO CHESSON ST)
 MAP 11 - SR 1311 - WOODLEY STATION (FROM SR 1310 TO TYRRELL CO LINE)
 MAP 12 - SR 1303 - DAVENPORT FORKS RD (FROM SR 1304 TO SR 1302)
TYPE OF WORK: RESURFACING

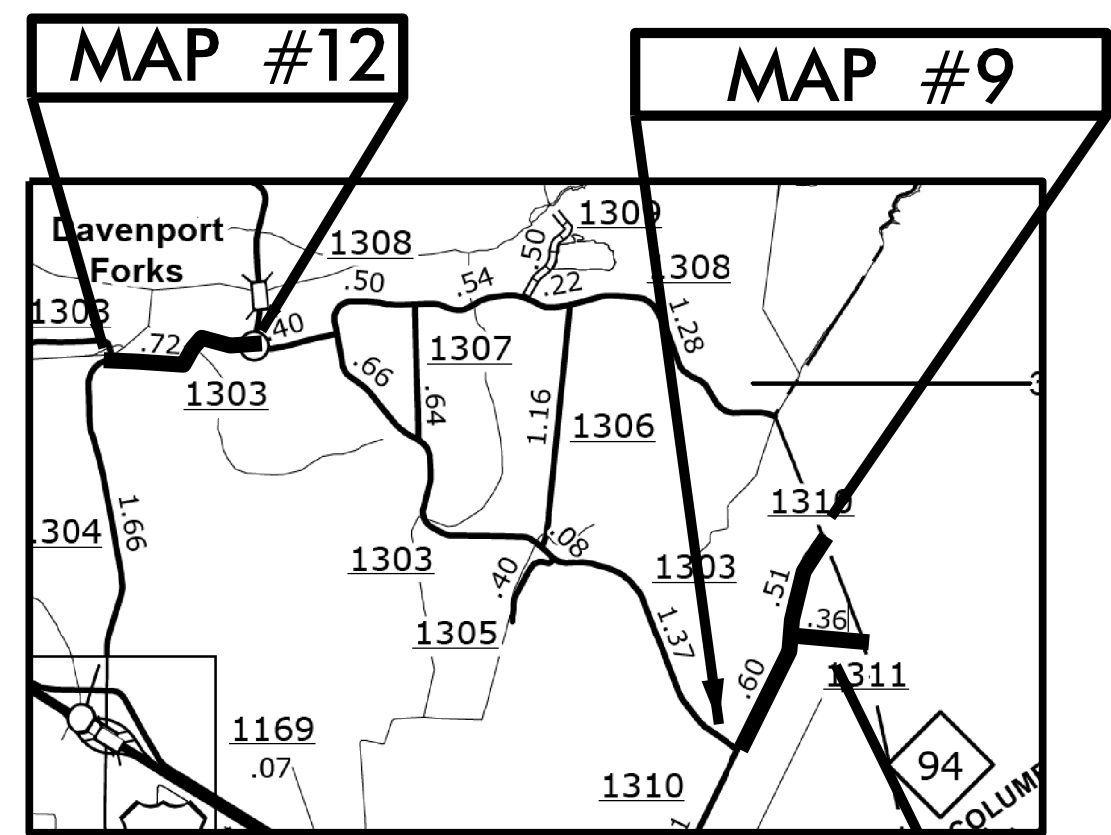
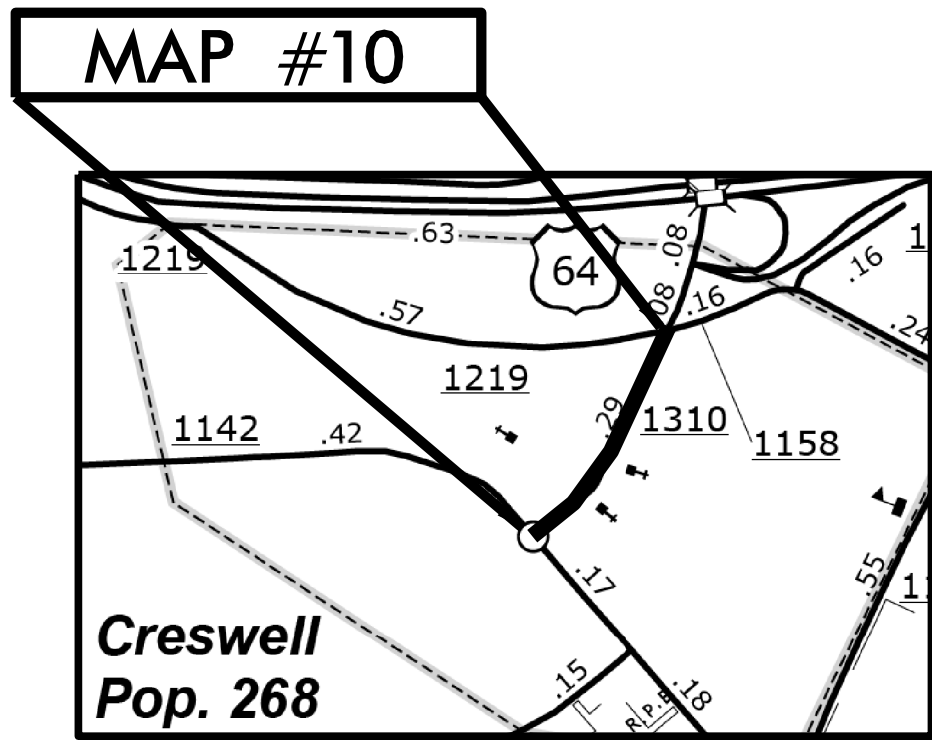

NOT TO SCALE

PROJECT LENGTH

LENGTH OF MAP 9 =	1.15 MI.
LENGTH OF MAP 10 =	0.20 MI.
LENGTH OF MAP 11 =	0.40 MI.
LENGTH OF MAP 12 =	0.68 MI.

Prepared in the Office of:
DIVISION OF HIGHWAYS
 113 Airport Dr., Edenton NC, 27932

2012 STANDARD SPECIFICATIONS

LETTING DATE: _____

W.B. HOBBS, P.E.
 DIVISION PROJECT MANAGER

C.E. SLACHTA
 DIVISION PROPOSALS ENGINEER

DIVISION OF HIGHWAYS
STATE OF NORTH CAROLINA

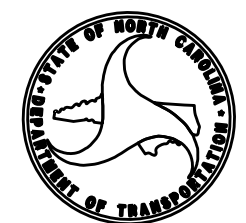

05/08/2018

CONTRACT: DA00383 WBS ELEMENT: 2018CPT.01.13.20941.1

STATE OF NORTH CAROLINA
DIVISION OF HIGHWAYS
WASHINGTON COUNTY

STATE	STATE PROJECT REFERENCE NO.	SHEET NO.	TOTAL SHEETS
N.C.	2018CPT.01.13.20941.1	6	
STATE PROJ. NO.	F.A. PROJ. NO.	DESCRIPTION	
2018CPT.01.13.20941.1		MAPS 13 - 15	

LOCATIONS: MAP 13 - SR 1108 - ROOSEVELT AVE (FROM NC 32 TO NC 32)
 MAP 14 - SR 1132 - BACKWOODS RD (FROM NC 32 TO SR 1135)
 MAP 15 - SR 1132 - BACKWOODS RD (FROM SR 1135 TO NC 32)

TYPE OF WORK: RESURFACING

MAP #13

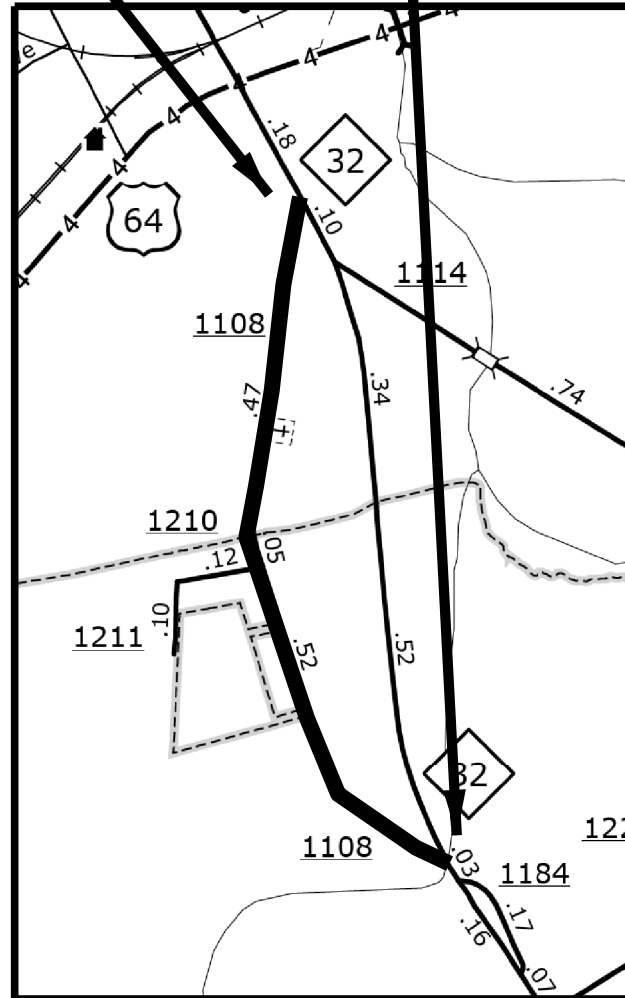

MAP #15

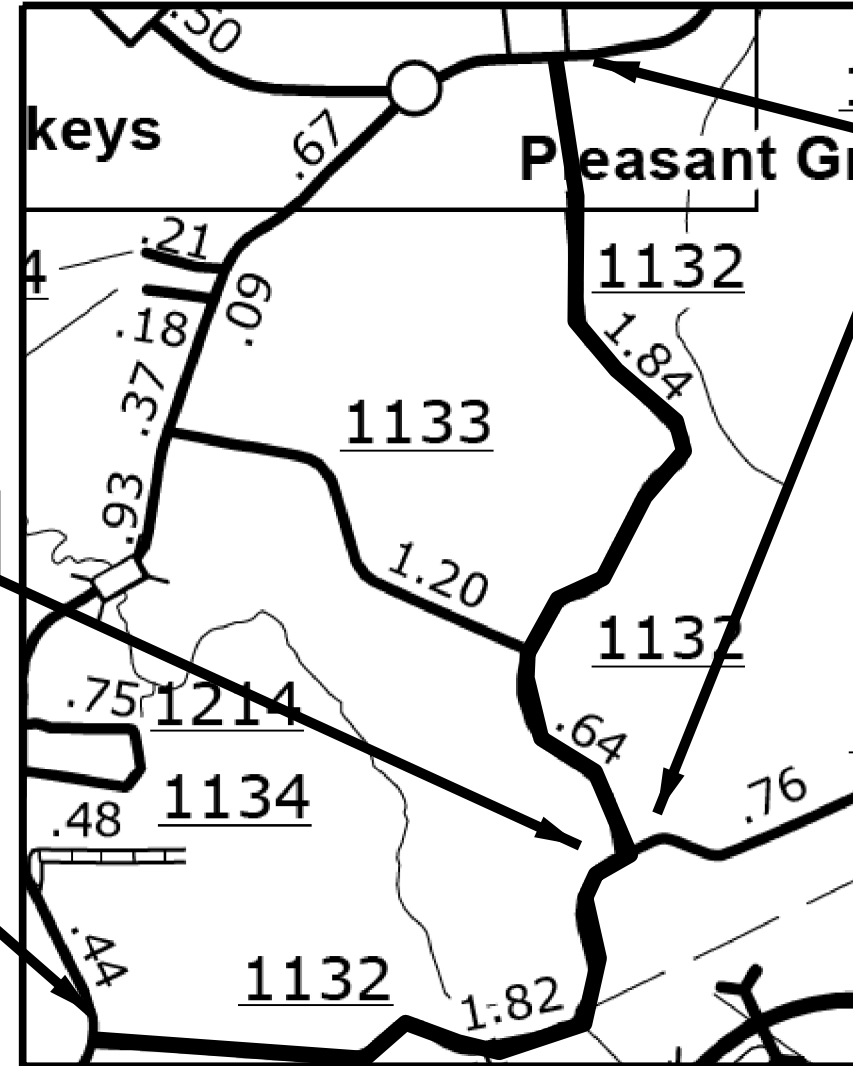

MAP #14

NOT TO SCALE

PROJECT LENGTH

LENGTH OF MAP 13 = 1.02 MI.
 LENGTH OF MAP 14 = 2.45 MI.
 LENGTH OF MAP 15 = 1.82 MI.

Prepared in the Office of:
DIVISION OF HIGHWAYS
 113 Airport Dr., Edenton NC, 27932

2012 STANDARD SPECIFICATIONS

LETTING DATE:

W.B. HOBBS, P.E.
 DIVISION PROJECT MANAGER

C.E. SLACHTA
 DIVISION PROPOSALS ENGINEER

DIVISION OF HIGHWAYS
 STATE OF NORTH CAROLINA

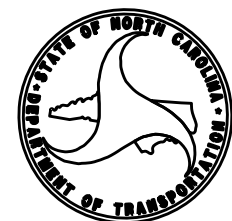

P A V E M E N T S C H E D U L E

C	PROP. APPROX. 1½" ASPHALT CONCRETE SURFACE COURSE, TYPE SF9.5A, AT AN AVERAGE RATE OF 168 LBS. PER SQ. YD.
U	EXISTING PAVEMENT.

NOTES:

*ALL PAVED S.R. ROADS TO BE RESURFACED TO THE ENDS OF THE RADII., OR AS DIRECTED BY THE ENGINEER.

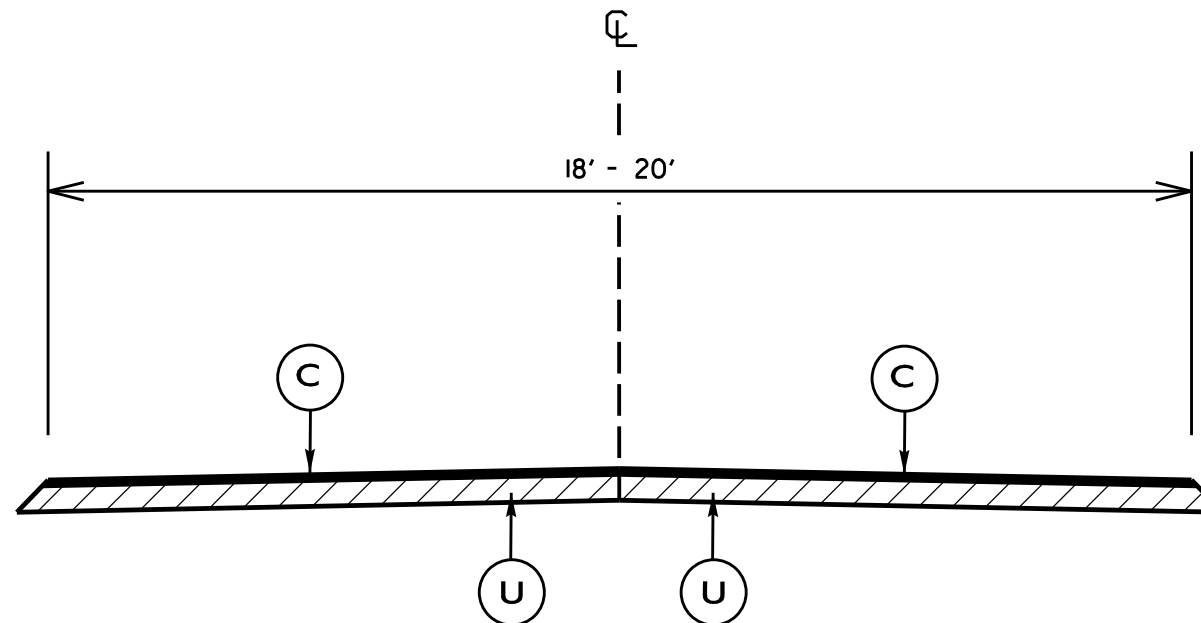

TYPICAL SECTION NO. 1

USE WITH MAPS 1 - 9 & MAPS 11, 12, 14, 15

NTS

SYSTEMS DESIGN CONSULTANTS
 1111 15th Street, Suite 1000
 San Francisco, CA 94103
 Tel: 415.774.2000
 Fax: 415.774.2001
 www.systemsdesign.com

PAVEMENT SCHEDULE

C	PROP. APPROX. 1.5" ASPHALT CONCRETE SURFACE COURSE, TYPE SF9.5A, AT AN AVERAGE RATE OF 168 LBS. PER SQ. YD.
V	MILLING BITUMINOUS PAVEMENT, 1.5" IN DEPTH.
U	EXISTING PAVEMENT.

NOTES:

*ALL PAVED S.R. ROADS TO BE RESURFACED TO THE ENDS OF THE RADII., OR AS DIRECTED BY THE ENGINEER

*CONTRACTOR SHALL MILL 1.5" BELOW EXISTING EDGE OF CONC. CURB & GUTTER.

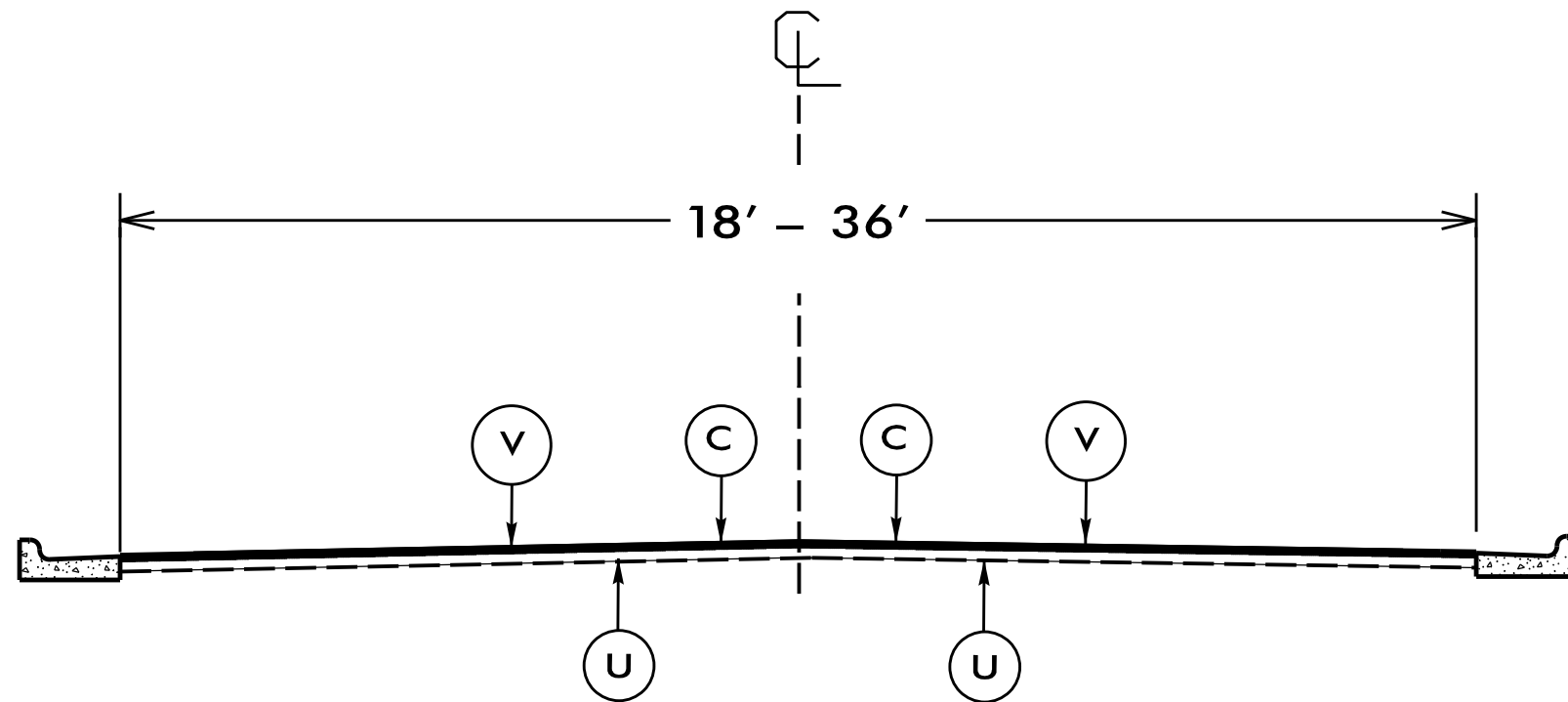

TYPICAL SECTION NO. 2

USE WITH MAPS 10 & 13

SYSTEMS DESIGN & CONSTRUCTION
 11000 W. CENTRAL EXPRESSWAY
 SUITE 200
 DENVER, CO 80202
 (303) 751-1100
 WWW.SDCONSTRUCTION.COM

PROJECT NO.	SHEET NO.
2018CPT.01.13.20481.1, ETC.	9

SUMMARY OF QUANTITIES

PROJECT NO	COUNTY	MAP NO	ROUTE	DESCRIPTION	TYP	LANES	LANE TYPE	FINAL SURFACE TESTING REQUIRED	WARM MIX ASPHALT REQUIRED	MTV REQUIRED	LENGTH MI	WIDTH FT	MOBILIZATION LS	1½" MILLING SY	INCIDENTAL MILLING SY	SURFACE COURSE, SF9.5A TONS	ASPHALT BINDER FOR PLANT MIX TONS	WORK ZONE ADV/GEN WARN SIGN SF	TEMPORARY TRAFFIC CONTROL LS
2018CPT.01.13.20481.1	Hyde	1	SR 1304 (TURNPIKE RD)	FROM SR 1305 TO US 264	1	2	2WU	NO	NO	NO	4.75	20	1		130	4,858	325	865	1
2018CPT.01.13.20891.1	Tyrrell	2	SR 1310 (OLD SWAMP RD)	FROM SR 1309 TO SR 1314	1	2	2WU	NO	NO	NO	2.21	20	*			2,260	151	402	*
2018CPT.01.13.20891.1	Tyrrell	3	SR 1314 (GUM NECK RD)	FROM SR 1310 TO SR 1315	1	2	2WU	NO	NO	NO	0.64	18	*			590	39	80	*
2018CPT.01.13.20891.1	Tyrrell	4	SR 1311 (CALIFORNIA RD)	FROM SR 1310 TO DEAD END	1	2	2WU	NO	NO	NO	0.12	18	*			111	7		*
2018CPT.01.13.20891.1	Tyrrell	5	SR 1318 (REEK RD)	FROM SR 1314 TO SR 1318	1	2	2WU	NO	NO	NO	0.46	20	*			470	32	80	*
2018CPT.01.13.20891.1	Tyrrell	6	SR 1318 (REEK RD)	FROM SR 1316 TO SR 1318	1	2	2WU	NO	NO	NO	0.23	18	*			212	14	80	*
2018CPT.01.13.20891.1	Tyrrell	7	SR 1209 (FORT LANDING RD)	FROM SR 1221 TO DEAD END	1	2	2WU	NO	NO	NO	3.66	18	*			3,371	226	546	*
2018CPT.01.13.20891.1	Tyrrell	8	SR 1224 (COVE RD)	FROM SR 1223 TO DEAD END	1	2	2WU	NO	NO	NO	0.21	18	*			193	13		*
2018CPT.01.13.20941.1	Washington	9	SR 1310 (ALLIGOOD RD)	FROM SR 1303 TO TYRRELL CO LINE	1	2	2WU	NO	NO	NO	1.15	20	*			1,176	79	182	*
2018CPT.01.13.20941.1	Washington	10	SR 1310 (6TH ST)	FROM SR 1142 TO CHESSON ST	2	2	2WU	NO	NO	NO	0.22	30	*	4,000		337	23	80	*
2018CPT.01.13.20941.1	Washington	11	SR 1311 (WOODLEY STATION)	FROM SR 1310 TO TYRRELL CO LINE	1	2	2WU	NO	NO	NO	0.40	18	*			368	25	80	*
2018CPT.01.13.20941.1	Washington	12	SR 1303 (DAVENPORT FORKS RD)	FROM SR 1304 TO SR 1302	1	2	2WU	NO	NO	NO	0.68	19	*			661	44	80	*
2018CPT.01.13.20941.1	Washington	13	SR 1108 (ROOSEVELT AVE)	FROM NC 32 TO NC 32	2	2	2WU	NO	NO	NO	1.02	18-26	*	13,900		1,164	78	182	*
2018CPT.01.13.20941.1	Washington	14	SR 1132 (BACKWOODS RD)	FROM NC 32 TO SR 1135	1	2	2WU	NO	NO	NO	2.45	19	*			2,381	160	364	*
2018CPT.01.13.20941.1	Washington	15	SR 1132 (BACKWOODS RD)	FROM SR 1135 TO NC 32	1	2	2WU	NO	NO	NO	1.82	18	*			1,676	112	364	*
GRAND TOTAL											20.02		1	17,900	130	19,828	1,328	3,385	1

SIGNING FOR RESURFACING PROJECTS

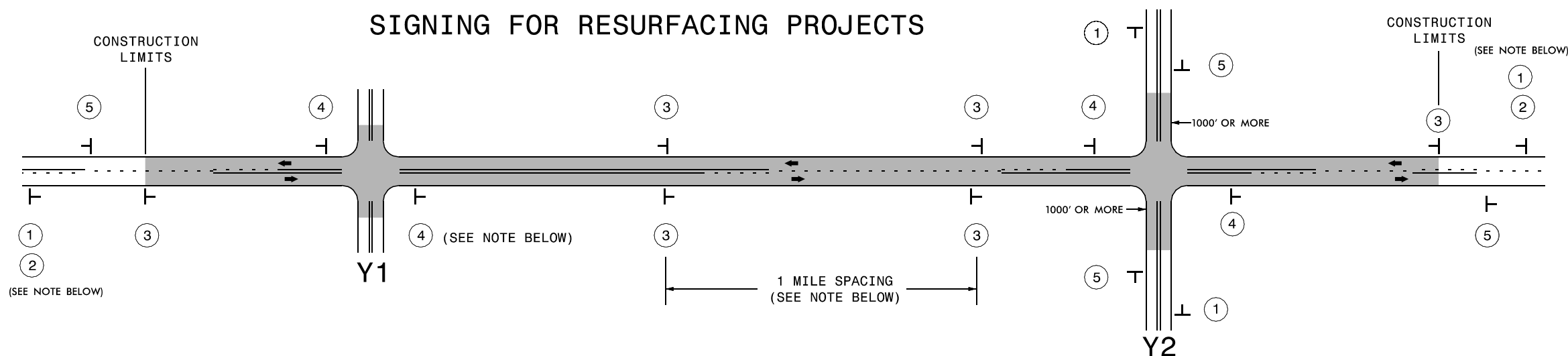

LEGEND	
┃	STATIONARY SIGN
←	DIRECTION OF TRAFFIC FLOW

MAINLINE (-L-) SIGNING

-Y- LINE SIGNING

SIGNING NOTES AND PLACEMENT PER DIRECTION	MAINLINE (-L-) SIGNING	-Y- LINE SIGNING
1	<p>PLACE 1000' PRIOR TO BEGINNING OF CONSTRUCTION LIMITS. ONLY USED ON -Y- LINES IF RESURFACING LIMITS EXTEND 1000' ALONG -Y- LINE.</p>	<p>NO REQUIRED STATIONARY SIGNING FOR THE FOLLOWING -Y- LINE CONDITIONS:</p> <ol style="list-style-type: none"> LESS THAN 1000' OF RESURFACING ALONG -Y- LINE SUBDIVISION ROADS DEAD END ROADS <p>WHEN PAVING/CONSTRUCTION ACTIVITIES PROCEED ACROSS AN UNSIGNED -Y- LINE, ADVANCE WARNING PORTABLE SIGNS SHALL BE USED ALONG THE -Y- LINE AS SHOWN BELOW. REMOVE UPON COMPLETION OF WORK.</p> <div style="display: flex; justify-content: space-around;"> <div style="text-align: center;"> <small>W20-1 48" X 48"</small> </div> <div style="text-align: center;"> <small>W20-7 A 48" X 48"</small> </div> </div> <p>PLACED 500' IN ADVANCE OF FLAGGER. PLACED 250' IN ADVANCE OF FLAGGER.</p>
2	<p>#2 SIGN ONLY USED WHEN RESURFACING LIMITS ARE 2 OR MORE MILES IN LENGTH. ROUND UP TO NEXT WHOLE NUMBER. (NO FRACTIONAL OR DECIMAL NUMBERS)</p>	
3	<p>PLACE INITIALLY AT THE CONSTRUCTION LIMITS AND SPACED 1 MILE APART THEREAFTER. IF NO -Y- LINES EXIST, PLACE 2ND SET 1/2 MILE FROM THE CONSTRUCTION LIMITS AND THEN SPACE 1 MILE THEREAFTER.</p>	
4	<p>THESE ARE FOR -Y- LINES THAT ARE "THROUGH" ROADWAYS. DEAD END AND SUBDIVISION ROADS ARE NOT "THROUGH" ROADWAYS. INSTALL 500' +/- FROM EACH -Y- LINE APPROACH AS SHOWN ABOVE. FOR MULTIPLE -Y- LINES THAT ARE SEPARATED BY 0.25 MILES OR LESS, TREAT AS A SINGLE UNIT AND INSTALL WITHIN 500' OF EACH APPROACH. A MAXIMUM OF 2 SIGN SETS PER MILE. DO NOT INSTALL WHEN -Y- LINES ARE WITHIN 0.5 MILES FROM "END ROAD WORK" SIGN.</p>	
5	<p>PLACE 500' FOLLOWING THE END OF CONSTRUCTION LIMITS.</p>	



RESURFACING
ADVANCE WARNING SIGNS
FOR
RURAL AND SUBURBAN
2 LANE ROADWAYS

- NOTES:
- 1) DETAIL DOES NOT APPLY TO OGAFc AND ULTRA-THIN BONDED WEARING COURSE.
 - 2) BACKFILL SHOULDER WITH APPROVED MATERIAL.
 - 3) THE SHOULDER WEDGE DEVICE MAY BE DISENGAGED AT PAVED DRIVEWAYS AND SIDE STREETS.

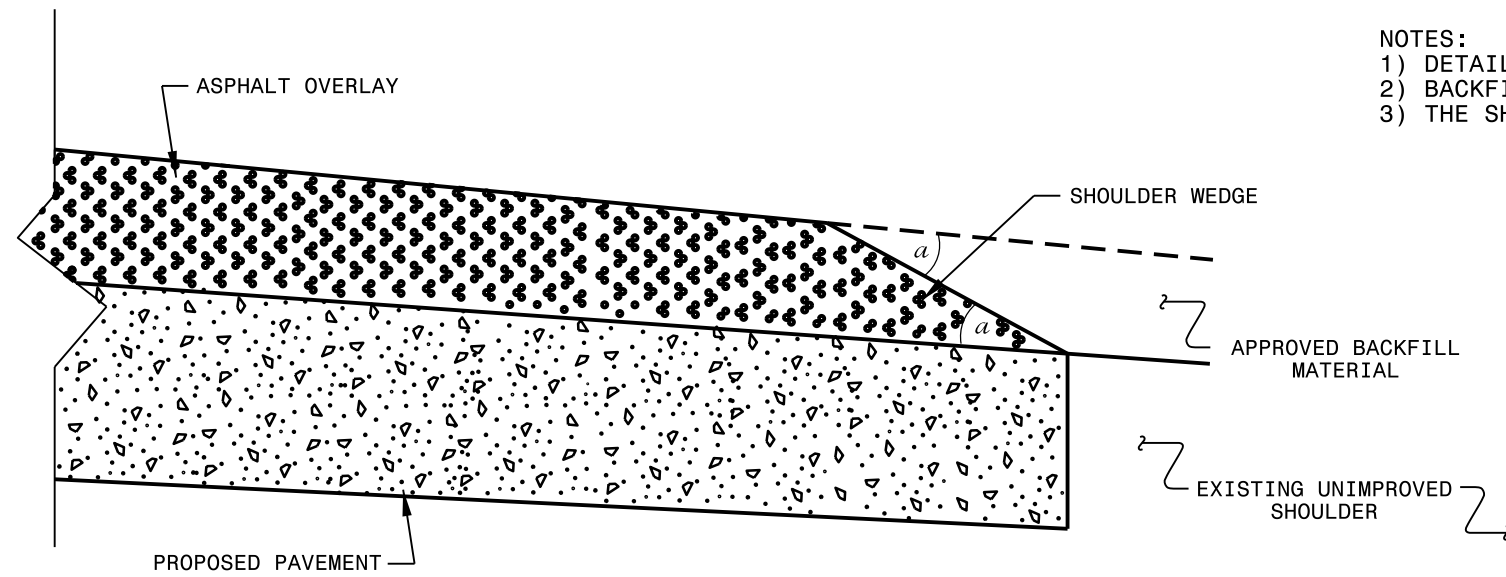

SHOULDER WEDGE DETAIL
(Resurfacing Projects w/ Widening or
with Existing Paved Shoulder having no dropoffs)

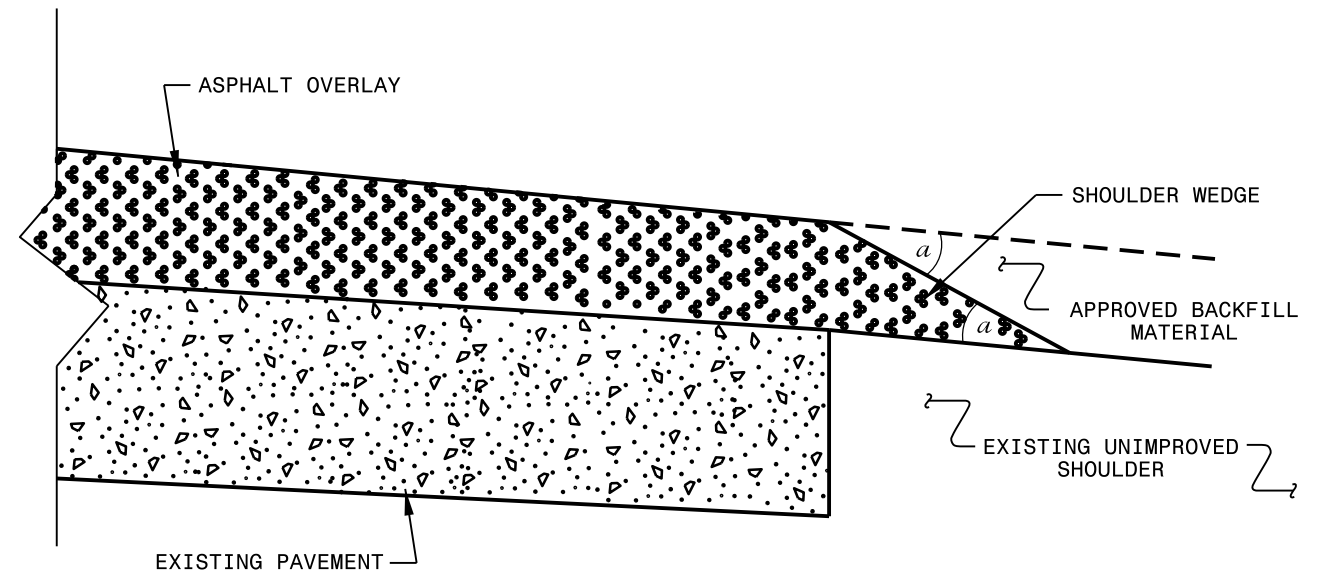

SHOULDER WEDGE DETAIL
(Resurfacing Projects w/ NO Widening)

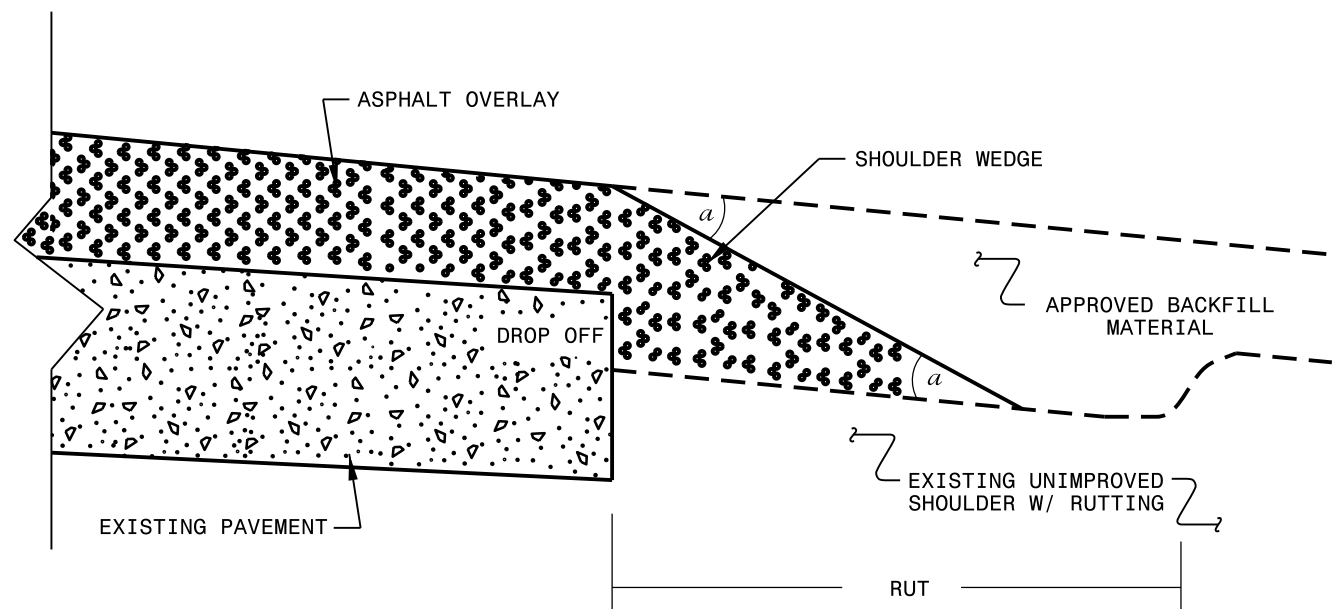

SHOULDER WEDGE DETAIL
(Resurfacing Adjacent to
Rutted Shoulder)

- SHOULDER WEDGE ANGLE = 30°

CONTRACT STANDARDS
AND DEVELOPMENT UNIT
Office 919-707-6950 FAX 919-250-4119

**SHOULDER WEDGE
DETAILS**

ORIGINAL BY: T.SPELL DATE: 7-19-11
 MODIFIED BY: DATE: 10/16/12
 CHECKED BY: DATE:
 FILE SPEC.: susr/details/stand/shoulderwedgedetail.dgn

SYSTEMS DESIGN
 USER NAME